



#### 4 Foundry Place Beechworth VIC

3  1 

Located on approximately 820sqm and privately set amongst established low maintenance gardens this three-bedroom, one-bathroom, steel-framed and colourbond clad home is only a short drive or walk to central Beechworth, Rail Trail cycling paths, public transport and popular walking tracks.

**Price** : \$ 553,000

**View** : <https://www.indigorealestate.com.au/sale/vic/north-eastern/beechworth/residential/house/6807659>

The welcoming undercover verandah provides wonderful and relaxing views across the surrounding ranges, private front gardens and leads to the spacious open plan, light-filled living area which features a generously sized lounge room with extensive windows, two ceiling fans, reverse-cycle air-conditioner and floating floors. The spacious and well-presented kitchen features electric cooking, double stainless-steel sink, good storage, excellent meal preparation areas and an adjacent dining area with a ceiling fan.



**Jaqui Ward**  
0357 283295

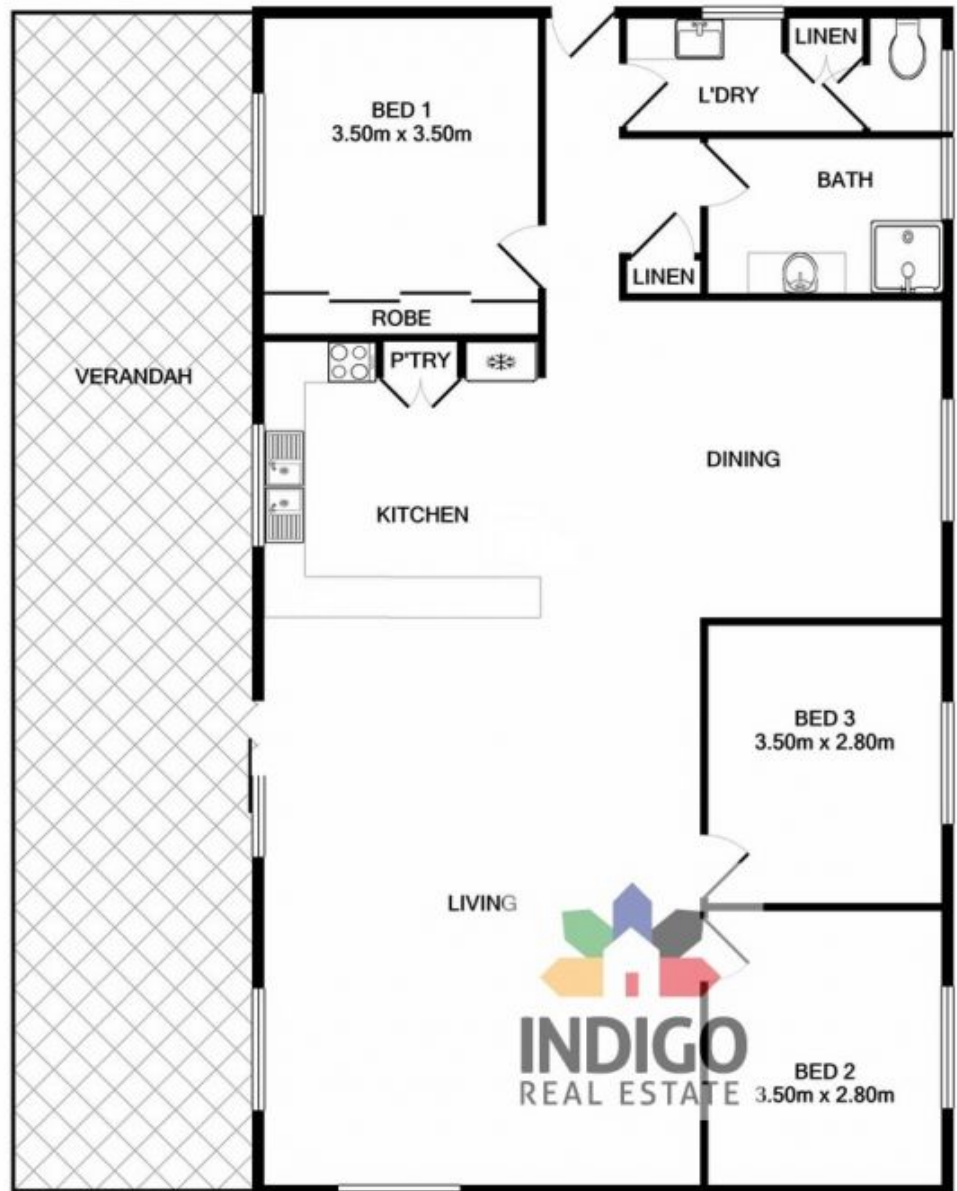
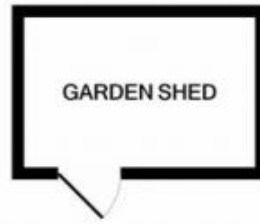

Measurements are approximate. Not to scale. Illustrative purposes only