





13 Brick Kiln Road Chiltern VIC

3  2  3 

Privately and peacefully located on approx. 10 acres this architecturally designed and built mudbrick home offers a uniquely multi-hexagonal floor plan currently configured to offer three bedrooms, study, separate dining, lounge, living areas and garage under roof totalling approx. 254sqm. Each of the six hexagonal 'pods' measure approx. 42sqm with the front and rear patios also continuing the hexagonal form.

This welcoming retreat style home includes the carpeted king-size master bedroom with French doors leading to the outside gardens, ceiling fan and a large walk-through-robe to the generously sized and tiled ensuite which is complete with shower, toilet and vanity basin.

The two additional carpeted bedrooms are double-sized and queen-sized respectively and offer convenient access

Price : \$ 555,000
Land Size : 10 Acres
View : <https://www.indigorealestate.com.au/sale/vic/north-eastern/chiltern/residential/house/5670275>



Jamie Horne
 0357 283295



Jaqui Ward
 0357 283295

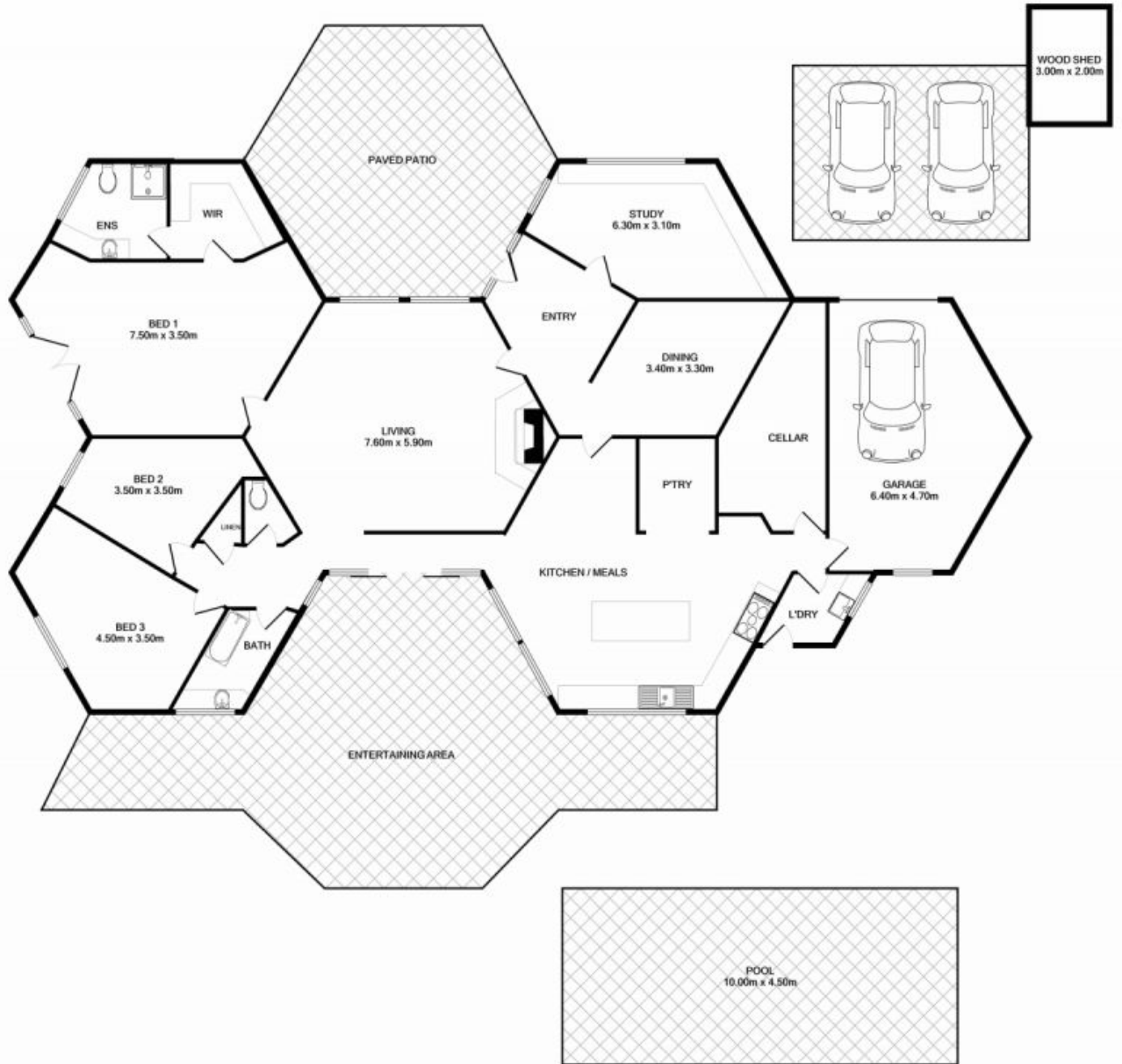

Measurements are approximate. Not to scale. Illustrative purposes only.