



### 44 Elgin Road Beechworth VIC

3  1  2 

Located at the end of a quiet country lane, only minutes from Beechworth township, this stylish property offers the best of both worlds. Forested with established deciduous trees and stately gums, the north western boundary of this secluded 4249m<sup>2</sup> allotment is set by a Bushland Reserve and Silver Creek with Lake Sambell and the Murray to Mountains walking and cycling trails nearby.

**Price** : \$ 515,000  
**Land Size** : 4249 sqm  
**View** : <https://www.indigorealestate.com.au/sale/vic/north-eastern/beechworth/residential/house/5670263>

Creatively inspired, this home is currently configured to offer two queen-size bedrooms, both of which feature high ceilings and ceiling fans; there is a potential third bedroom if required. The central loungeroom includes a gas log heater and access to the generously proportioned and the recently updated tiled bathroom which includes a shower, toilet, basin and claw-foot bath.

Located to the rear of this home is a welcoming kitchen and



**Jamie Horne**  
 0357 283295



**Jaqui Ward**  
 0357 283295

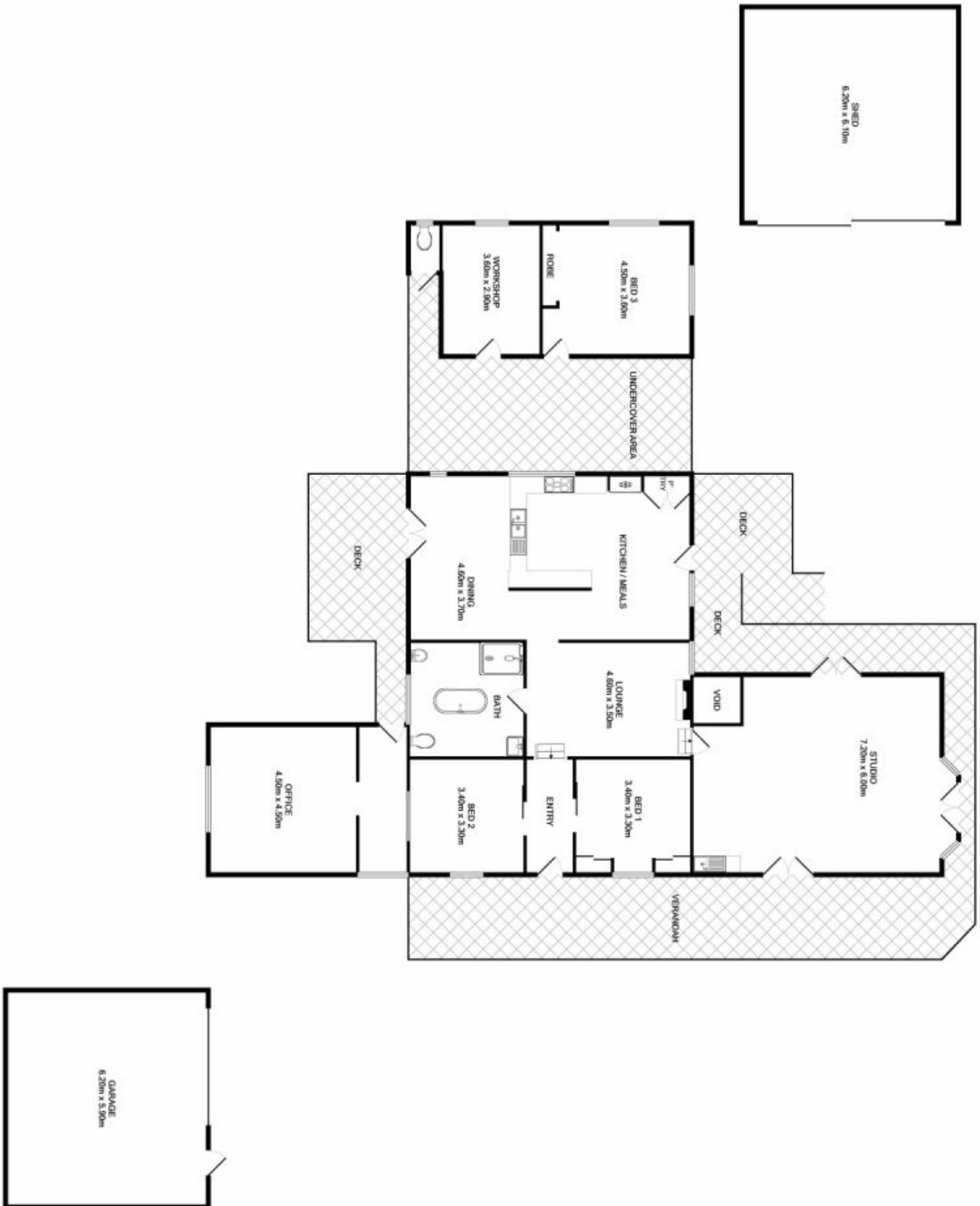

Maatwerk en opties zijn niet inbegrepen. Na te stellen. (Bijlage Projecten 100)