



### 15 Frederick Street Beechworth VIC

3  1  2 

Located on an allotment of approx. 1060sqm this charming cottage styled home offers multiple spacious living areas and three generously sized bedrooms. Ideal for families or couples this home includes a spacious King-size master bedroom and two additional double bedrooms, both with built-in-robies, carpets and ceiling fans. There is also a centrally located study / craft room complete with a built desk and built-in storage.

**Price** : \$ 305,000  
**Land Size** : 1060 sqm  
**View** : <https://www.indigorealestate.com.au/sale/vic/north-eastern/beechworth/residential/house/5670039>

This home offers plenty of living area with a separate dining room in addition to a large formal lounge with a wood fire, pressed metal ceilings and French doors to the gardens. The kitchen is spacious and includes a pantry, good storage, electric oven and cook top, reverse cycle air-conditioning and views across the adjacent parklands.



**Jamie Horne**  
 0357 283295

This home has a dedicated 'wet' area with a laundry and



TOTAL APPROX. FLOOR AREA 144.1 SQ.M. (1551 SQ.FT.)

For illustrative purposes only. Decorative finishes, fixtures, fittings and furnishings do not represent the current state of the property. Measurements are approximate. Not to scale

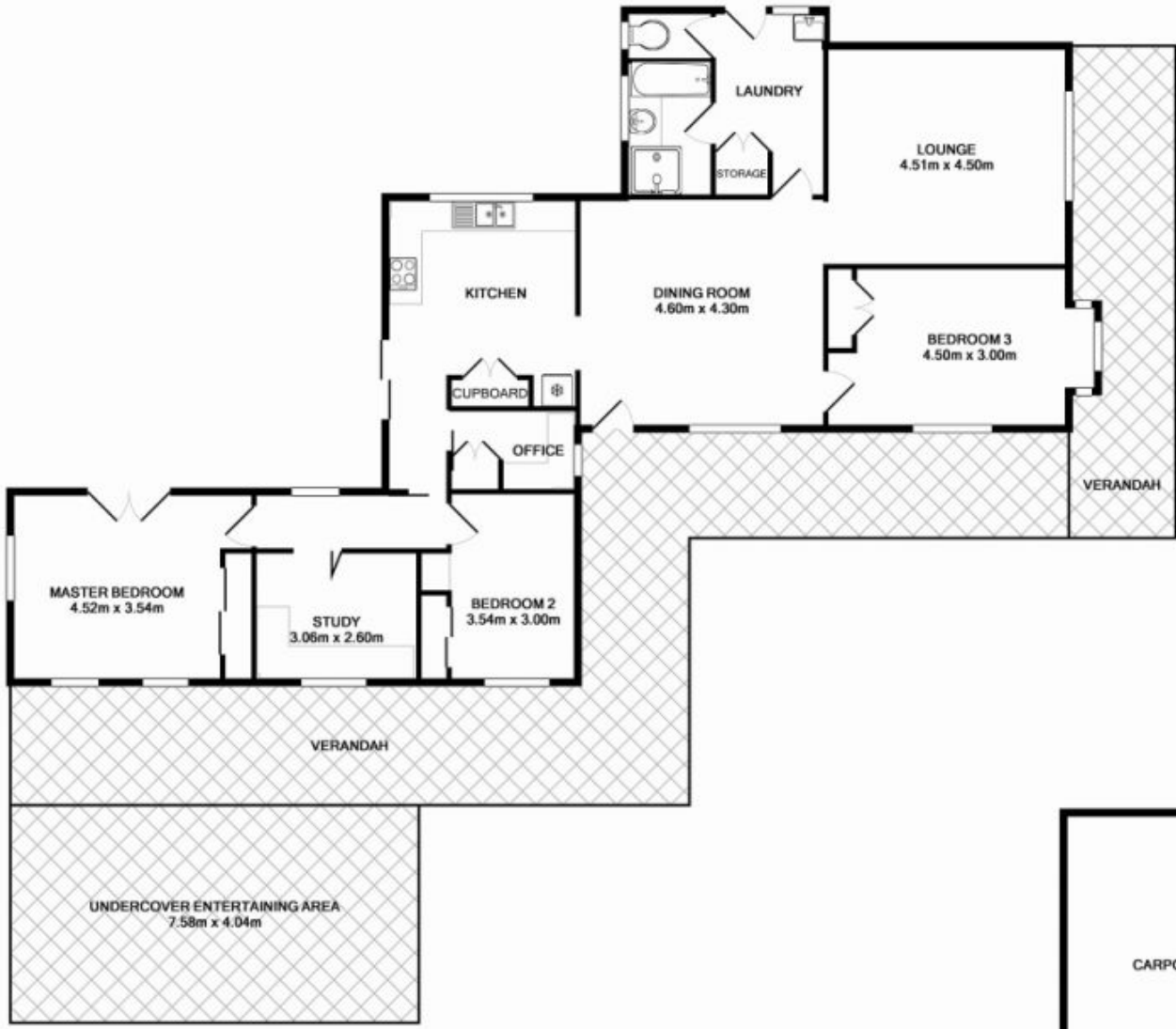

TOTAL APPROX. FLOOR AREA 144.1 SQ.M. (1551 SQ.FT.)  
 Measurements are approximate. Not to Scale. For illustrative purposes only.