





### 2/11 Priory Lane Beechworth VIC

3  1  2 

If you are looking for a centrally located, low maintenance 3 bedroom, 1 bathroom townhouse only 2 minutes stroll to central Beechworth and close to the supermarket, churches and cafes this home is a must see.

Privately positioned at the rear of the 2 townhouse development this home features a master King-size bedroom and a Queen-size bedroom both have generous built-in-robies a single bedroom which is also ideal as a home study.

The open-plan Blackwood kitchen is as new with plenty of storage and an adjacent dining area with sliding doors leading to the low maintenance rear garden. The lounge is proportionately generous and has sliding doors to the front under cover pergola and outdoor sitting and entertaining area overlooking the private low maintenance front

**Price** : \$ 295,000  
**Land Size** : 427 sqm  
**View** : <https://www.indigorealestate.com.au/sale/vic/north-eastern/beechworth/residential/townhouse/5670005>



**Jamie Horne**  
 0357 283295



For illustrative purposes only. Decorative finishes, fixtures, fittings and furnishings do not represent the current state of the property. Measurements are approximate. Not to scale

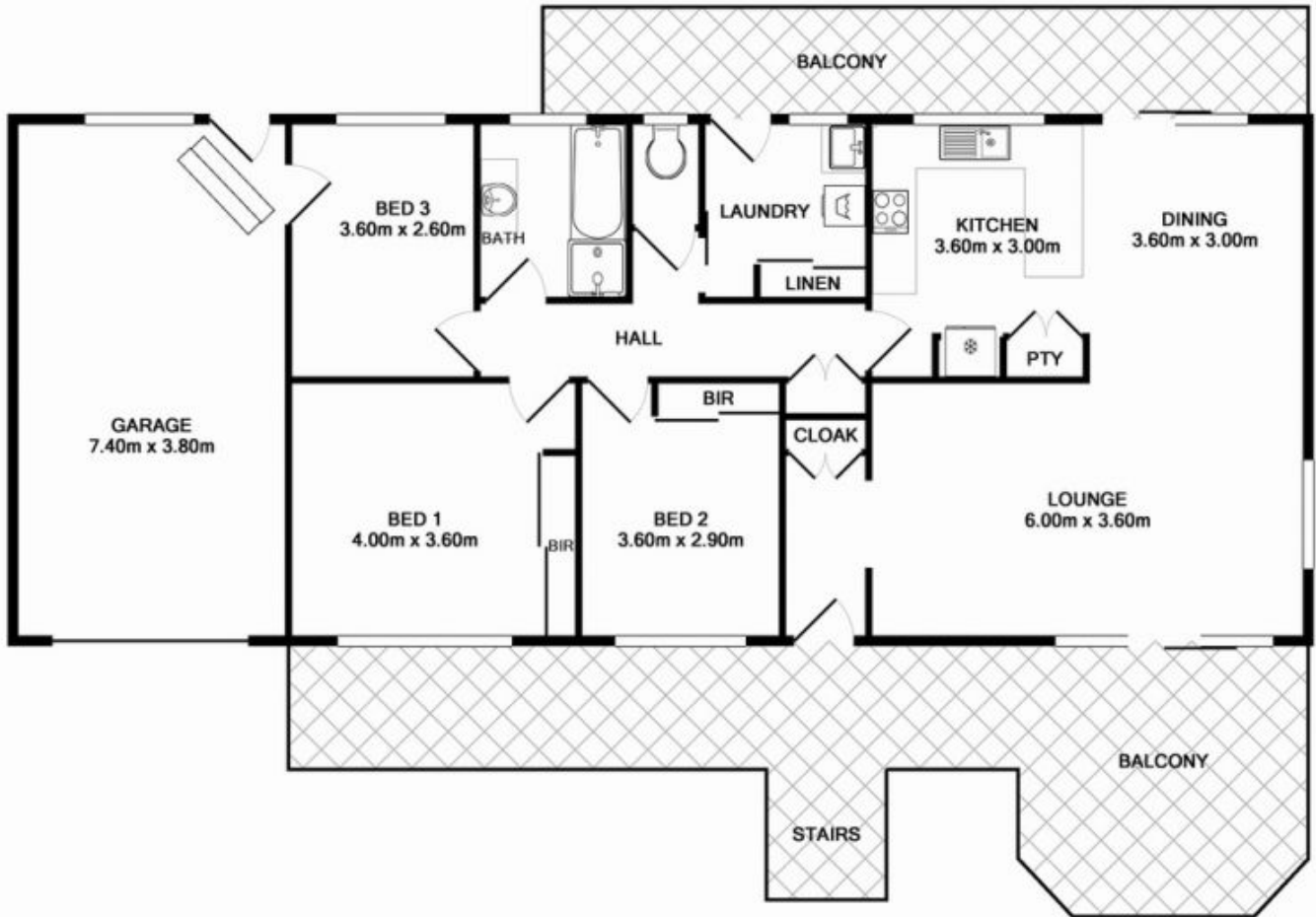

Measurements are approximate. Not to Scale. For illustrative purposes only.